

# Glazed Tiles (hand painted and Zellige)

## Installation Guide/Sealing/Aftercare

The following directions are intended for professional tradesmen. Please consult a professional in all cases.

Maitland & Poate's glazed hand painted and zellige collection is a versatile surfacing solution designed for both **interior and exterior** environments. Its durability makes it an ideal choice for a wide range of residential and commercial applications, including:

- **Surfaces:** Floors, walls, and countertops.
- **Wet Areas:** Showers, bathrooms, and spas.
- **Water Features:** Swimming pools and fountains. (please consult since not all tiles are appropriate)

**CONTINUED ON NEXT PAGE**

# Glazed Tiles (hand painted and Zellige)

## Installation Guide/Sealing/Aftercare

### About the material

#### Glazed Tiles

A liquid colour glaze is applied to the clay body before the tiles are fired in a kiln at high temperatures. This specialised glazing process defines both the final colour and the surface texture. The result is a hard, non-porous, and impermeable tile with an exceptionally low water absorption rate. Consequently, glazed tiles are easier to maintain, as liquids drain more efficiently from the surface.

#### Size and Length Variation

Due to the natural shrinkage that occurs during the production process, some dimensional variation is to be expected. These variations are most common and noticeable in longer tile formats.

#### Lengthwise Bowing and Surface Undulation

Clay is an elastic material that naturally attempts to return to its original form as it moves through the manufacturing stages. Because of this characteristic, you may observe an acceptable degree of lengthwise bowing or surface undulation. This undulation can appear anywhere on the tile, sometimes manifesting as a slightly raised edge or corner.

#### Colour and Glaze Variation

Shade variation is an inherent quality of all ceramic products. Certain tiles will exhibit more pronounced differences within their specific dye lots. Natural pigments are used to create these tiles.

Additionally, note that glaze thickness may vary on tiles; this results in natural "pooling" or thinning of the glaze, creating lighter and darker areas across the tile surface.

# Glazed Tiles (hand painted and Zellige)

## Installation Guide/Sealing/Aftercare

### Layout and Pre-Installation Planning

Careful planning is the foundation of a successful project. The time invested in preparation and strategic placement will significantly enhance the final aesthetic of your installation.

- **Pre-sort and Organize:** Group your tiles by colour and size prior to installation. This allows you to intentionally distribute the natural range of variations across the entire surface.
- **Blend for Consistency:** We strongly recommend blending tiles from different boxes during the layout process to ensure a balanced, harmonious appearance.
- **Quality Inspection:** Examine every tile for cracks or other physical deformities. Ensure each piece is appropriate for its intended application before setting it in mortar.

# Glazed Tiles (hand painted and Zellige)

## Installation Guide/Sealing/Aftercare

### Grout

We recommend a grout joint width of **1 mm to 4 mm**. Because of the artisanal nature of these tiles, the edges possess natural imperfections; when tiles are placed together, they will create a charmingly irregular space even where they appear to touch.

- **Adjustable Alignment:** Grout joint widths can be slightly varied during installation to better align the layout with adjacent handmade tiles or specific architectural features.
- **Aesthetic Impact of Grout Colour:** The choice of grout colour significantly influences the final look of the project.
  - **To Accentuate:** Use a contrasting grout colour to create a bold border effect around each tile.
  - **To Harmonise:** Choose a grout hue that closely matches the tones within the tile to create a seamless, interconnected appearance across the surface.

# Glazed Tiles (hand painted and Zellige)

## Installation Guide/Sealing/Aftercare

### Installing your tiles

#### Installation Standards and Materials

Install all products in accordance with established industry standards for glazed terracotta tiles. Achieving a durable, long-lasting installation depends entirely on proper substrate preparation and the selection of high-quality adhesives and grouts tailored to your specific project environment.

**Maitland & Poate** tiles are compatible with all conventional tiling methods. For optimal results, we recommend the following material specifications:

- **Adhesives:** Use high-performance adhesives rated **EN 12004 C2** (or equivalent).
- **Grout Compounds:** Select grout compounds rated **EN 13888** suitable for wall and floor applications.
- **Versatility:** These tiles are compatible with any standard mortars and setting materials designed for use with ceramic or terracotta tiles.

# Glazed Tiles (hand painted and Zellige)

## Installation Guide/Sealing/Aftercare

### Installing your tiles

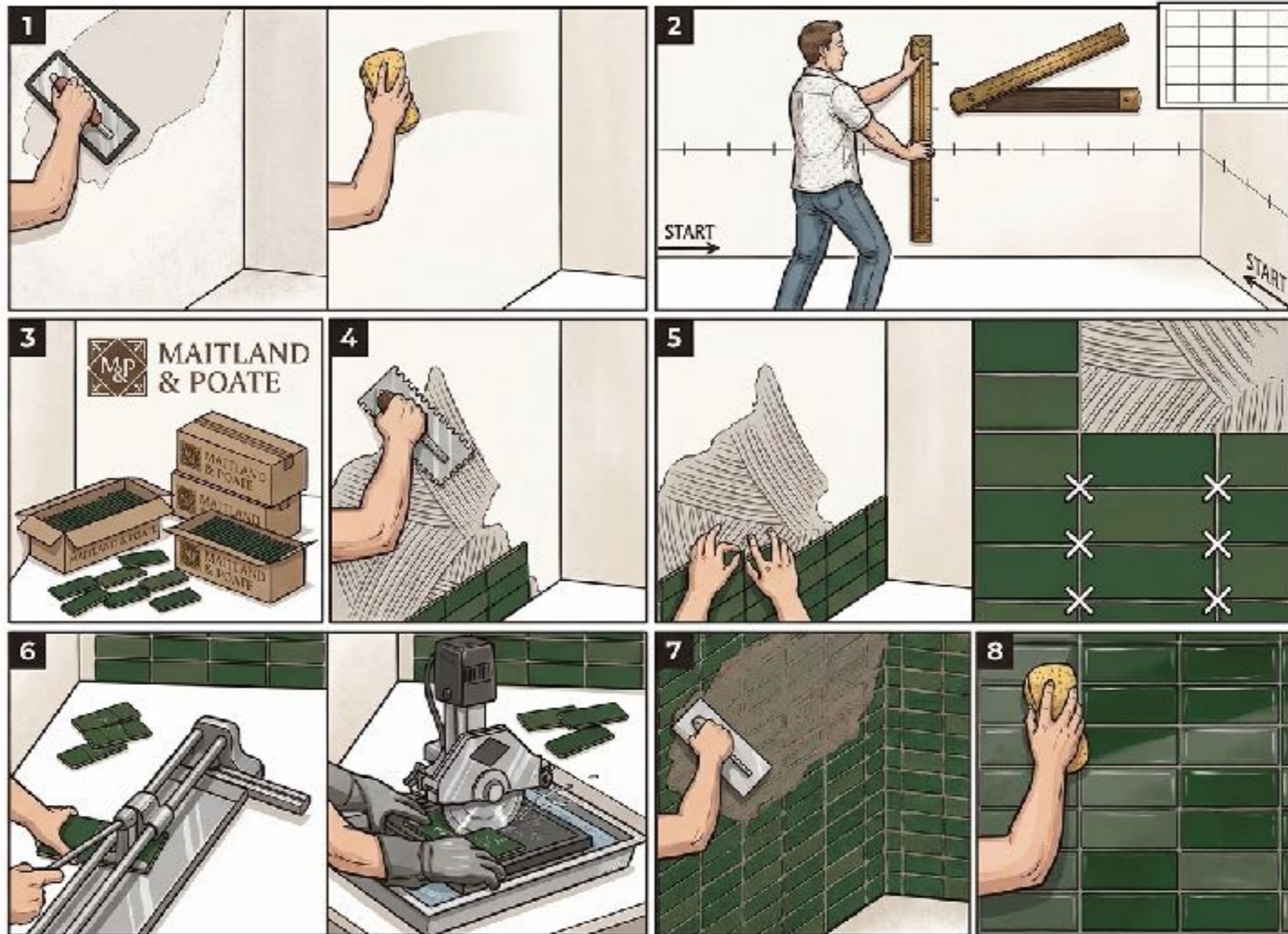

# Glazed Tiles (hand painted and Zellige)

## Installation Guide/Sealing/Aftercare

### Installing your tiles

Follow these eight steps to ensure a professional and beautiful finish for your **Maitland & Poate** tiles:

- 1. Substrate Preparation:** Ensure the installation surface is clean, perfectly level, and fully cured. A stable, debris-free base is essential for a long-lasting bond.
- 2. Layout Planning:** Map out your tile placement and mark the surface. Identify your starting points and plan your cuts ahead of time to optimise both the technical fit and the final aesthetic.
- 3. Tile Distribution:** Open multiple boxes and pre-sort tiles by size and shade. Mix them thoroughly during installation to achieve a balanced distribution of natural colour variations.
- 4. Adhesive Application:** Apply a suitable tile adhesive to the substrate. Use a large-notched trowel to ensure an even, consistent bed of mortar.
- 5. Setting the Tiles:** Place the tiles onto the adhesive, aligning them carefully and pressing firmly to ensure full coverage. For consistent alignment, we recommend using X-shaped tile spacers.
- 6. Cutting to Fit:** If tiles require trimming for edges or corners, use a manual snap cutter or a wet saw for precise, clean lines.
- 7. Grouting:** Once the adhesive has cured—typically after 24 hours—fill the joints with your chosen grout. Work the material into the spaces using a rubber grout float.
- 8. Final Clean-up:** Immediately remove any excess grout from the tile surface using a damp sponge. Rinse the sponge frequently in clean water to prevent a grout haze from forming.

# Glazed Tiles (hand painted and Zellige)

## Installation Guide/Sealing/Aftercare

### Maintenance

Maitland & Poate tiles are designed for longevity and require minimal upkeep beyond routine cleaning. To preserve the inherent beauty and finish of your installation, we recommend the following care guidelines:

- **Routine Cleaning:** For daily maintenance, use a **pH-balanced natural cleaner** diluted in warm water. This effectively removes surface dust without damaging the glaze.
- **Targeted Cleaning:** To address stubborn spots or to refresh grout lines, use a **stiff natural bristle brush**.
- **Avoid Harsh Chemicals:** Never use cleaning products containing **bleach, ammonia, or paint thinners**, as these can compromise the tile surface.
- **Prevent Scratches:** Avoid abrasive tools such as wire wool, metal scouring pads, or hard-bristled brushes, which may permanently scratch the glaze.
- **Kitchen Care:** In cooking areas—particularly around stoves and backsplashes—clean oil splatters immediately. If left to sit, cooking oils may penetrate and darken the appearance of certain tiles.

# Glazed Tiles (hand painted and Zellige)

## Installation Guide/Sealing/Aftercare

### Products to use

PRODUCT	USE	ADHESIVE	GROUT
Handmade Glazed Tiles	Interior Walls Interior Wet Areas	MAPEI Keraflex	Mapei Ultracolor Plus
	Exterior Walls	MAPEI Keraflex Extra S1	Mapei Ultracolor Plus
	Swimming Pools	MAPEI Keraflex Extra S1	Mapei Kerapoxy CQ

# Glazed Tiles (hand painted and Zellige)

## Installation Guide/Sealing/Aftercare

### FAQ's

**Are all Maitland & Poate tiles suitable for every purpose?** No. Suitability depends on the specific glaze. Some are recommended strictly for wall use, while others are not compatible with swimming pools. Please consult us for specific usage details before finalising your selection.

**Can your tiles be used around a fireplace? Are they heat-resistant?** Yes. Our tiles are kiln-fired at extremely high temperatures, making them naturally heat-resistant. They are perfectly suited for fireplace surrounds and will not be damaged by the heat.

**Are these tiles suitable for showers and wet areas?** Yes, our collection is ideal for wet applications. Please note that in areas with regular water exposure, such as showers, it is natural for some tiles to temporarily darken when wet and lighten as they dry.

**Can I use these tiles in exterior applications?** Our tiles have been successfully installed on vertical exterior surfaces (walls) for many years without issue. However, we do not recommend them for horizontal exterior surfaces (floors). Please contact us directly to discuss the specific requirements of your outdoor project.

**Which tiles are safe for pools or fountains?** We offer several glazes specifically rated for pool use. Please refer to our **Glaze Guide** to identify which options are suitable for submerged environments.

### Layout & Installation

**Can I mix different colours and sizes?** Absolutely. Many of our shapes and dimensions are designed to be used in tandem. For inspiration and technical compatibility, please see the "Layouts" section in our **Format Guide**.

# Glazed Tiles (hand painted and Zellige)

## Installation Guide/Sealing/Aftercare

### FAQ's continued

**Does a diagonal layout require more material?** Yes. Setting tiles on a diagonal typically results in more waste than a standard straight-set pattern. We recommend consulting with your professional installer to determine the exact overage required for your specific space.

**What grout joint size do you suggest?** Maitland & Poate tiles are sized to accommodate a grout space of **1 mm to 4 mm**, depending on the format. Since many factors influence the ideal joint size, we recommend discussing a jointing scheme with both your architect and installer.

### Sealing & Maintenance

**Do I need to seal glazed tiles?** Generally, our glazed tiles do not require sealing. However, tiles featuring **craquelé (crackle) glazes** should be sealed prior to grouting in certain environments to protect the integrity of the finish.

**What is the best way to clean my tiles?** For daily care, use a **pH-balanced natural cleaner**. We strictly advise against using any acid-based cleaners. It is always best practice to test any new cleaning method on an inconspicuous area first.